



KONICA MINOLTA

bizhub 4700i

Black & White A4 printer

**bizhub
i-SERIES IS
SMARTER
WORKING**
RETHINK IT



Giving Shape to Ideas

CUSTOMER BENEFITS



Intuitive operability

Operate the bizhub like a smartphone or tablet with fully customized user interface



Mobile connectivity

Print anytime from anywhere with Konica Minolta's innovative mobile technologies



Services

Efficient printer fleet management, including automatic consumables delivery, pro-active maintenance and remote setup



Sustainability

Numerous eco features reduce energy consumption and costs

OPTIONS

1 CONNECTIVITY

Wireless LAN

UK-221

USB I/F kit

EK-P08

USB I/F kit

EK-P09

NFC I/F kit

EK-P10

Biometric authentication

AU-102

ID card reader

Mount kit

MK-P07

2 OTHERS

10-Key pad

KP-P03

Keyboard holder

KH-P02

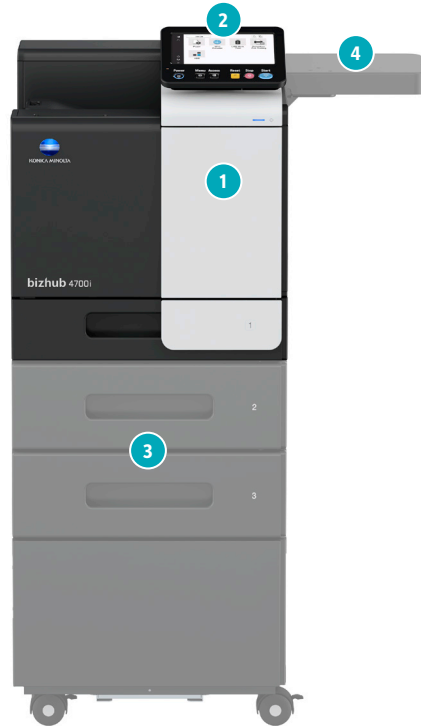

3 MEDIA INPUT

Paper tray

PF-P21

Height adjustment unit

PF-P25

Copier desk

DK-P05

4 MEDIA OUTPUT

Off-line stapler

FS-P04

Staple kit

SK-501

Working table

WT-P03

LEGEND

- Mandatory option
- Option
- This option can only be installed with the respective option above it

FINISHING FUNCTIONALITIES



Duplex



Corner
Stapling
(offline)

DESCRIPTION

CONNECTIVITY

UK-Z21 Wireless LAN	Wireless LAN and wireless LAN Access Point Mode
EK-P08 USB I/F kit	USB keyboard connection
EK-P09 USB I/F kit	USB keyboard connection; Bluetooth
EK-P10 NFC I/F kit	To connect with Android mobile devices
AU-102 Biometric authentication	Finger vein scanner
ID card reader Card authentication	Various ID card technologies
MK-P07 Mount kit	Mount kit for ID card reader

OTHERS

WT-P03 Working table	Authentication device placement
KP-P03 10-Key pad	For use instead of touchscreen
KH-P02 Keyboard holder	To place USB keyboard

MEDIA INPUT

PF-P21 Paper tray	500 sheets, A4, 60-90 g/m ² ; 80g/m ²
PF-P25 Height adjustment unit	To achieve comfortable height for operation
DK-P05 Copier desk	Provides storage space for print media and other materials

MEDIA OUTPUT

FS-P04 Off-line stapler	20-sheet off-line stapling
-------------------------	----------------------------

TECHNICAL SPECIFICATIONS

SYSTEM SPECIFICATIONS

System speed letter	Up to 50 ppm
Auto duplex speed letter	Up to 50 ppm
1st page out time letter	7.4 sec.
Warm-up time ¹	Approx. 18 sec.
Imaging technology	Laser
Toner technology	Simitri® HD polymerized toner
Panel size/resolution	7" / 800 x 480
System memory	4 GB (standard/max)
Micro SD	8 GB (standard)
Interface	10/100/1,000-Base-T Ethernet; USB 2.0; USB 3.0; Wi-Fi 802.11 b/g/n/ac (optional)
Network protocols	TCP/IP (IPv4 / IPv6); SMB; LPD; IPP; SNMP; HTTP(S); Bonjour
Printable paper size	A6-A4; customized paper sizes
Printable paper weight	60-210 g/m ²
Paper input capacity	600 sheets / 1,600 sheets (standard/max)
Paper tray input (standard)	1x 500; A6-A4; custom sizes; 60-210 g/m ²
Paper tray input (optional)	1x 500 sheets; A4; 60-90 g/m ² (up to 2x)
Manual bypass	100 sheets; A6-A4; custom sizes; 60-210 g/m ²
Finishing modes (optional)	Group; Sort; Staple (offline)
Automatic duplexing	A4; 60-210 g/m ²
Output capacity	Up to 250 sheets
Duty cycle (monthly) ²	Max. 120,000 pages
Toner lifetime	Up to 20,000 pages
Imaging unit lifetime	Up to 200,000 pages (imaging unit)
Power consumption	110-127V / 50/60 Hz; Less than 1.45 kW
System dimension (W x D x H)	16.5" x 20.8" x 18.6" (without options)
System weight	Approx. 64 lbs (without options)

PRINTER SPECIFICATIONS

Print resolution	1200 x 1200 dpi
Page description language	PCL 6 (XL3.0); PCL 5c; PostScript 3 (CPSI 3016); XPS
Operating systems	Windows 7 (32/64); Windows 8.1 (32/64); Windows 10 (32/64); Windows Server 2008 (32/64); Windows Server 2008 R2; Windows Server 2012; Windows Server 2012 R2; Windows Server 2016; Windows Server 2019; Macintosh OS X 10.10 or later; Unix; Linux; Citrix
Printer fonts	80 PCL Latin; 137 PostScript 3 Emulation Latin
Mobile printing	AirPrint (iOS), Mopria (Android); Konica Minolta Print Service (Android); Konica Minolta Mobile Print (iOS/Android) optional: WiFi Direct

SYSTEM FEATURES

Security Functions (standard)	ISO 15408 HCD-PP Common Criteria (in evaluation); IP filtering and port blocking; SSL2; SSL3 and TLS1.0/1.1/1.2 network communication; IPsec support; IEEE802.1x support; User authentication; Authentication log; Secure print; Kerberos; Print user data encryption
Accounting	Up to 100 user accounts; Active Directory support (user name + password + e-mail + smb folder) optional: Biometric authentication (finger vein scanner); ID card authentication (ID card reader); Authentication by mobile device (Android/iOS)
Software	Net Care Device Manager; Data Administrator; Box Operator; Web Connection; Print Status Notifier; Driver Packaging Utility; Log Management Utility

¹ Warm-up time may vary depending on the operating environment and usage

² If the maximum volume is reached within a period of one year, then a maintenance cycle must be performed

- All specifications refer to A4-size paper of 80 g/m² quality.
- The support and availability of the listed specifications and functionalities varies depending on operating systems, applications and network protocols as well as network and system configurations.
- The stated life expectancy of each consumable is based on specific operating conditions such as page coverage for a particular page size (6% coverage of A4). The actual life of each consumable will vary depending on use and other printing variables including page coverage, page size, media type, continuous or intermittent printing, ambient temperature and humidity.
- Some of the product illustrations contain optional accessories.
- Specifications and accessories are based on the information available at the time of printing and are subject to change without notice.
- Konica Minolta does not warrant that any specifications mentioned will be error-free.
- All brand and product names may be registered trademarks or trademarks of their respective holders and are hereby acknowledged.



For complete information on Konica Minolta products and solutions, please visit: [CountOnKonicaMinolta.com](https://www.CountOnKonicaMinolta.com)

© 2021 KONICA MINOLTA BUSINESS SOLUTIONS U.S.A., INC. All rights reserved. Reproduction in whole or in part without written permission is prohibited. KONICA MINOLTA, the KONICA MINOLTA logo and bizhub are registered trademarks or trademarks of KONICA MINOLTA, INC. All other product and brand names are trademarks or registered trademarks of their respective companies or organizations. All features and functions described here may not be available on some products. Design & specifications are subject to change without notice.

PARTNERSHIP

Konica Minolta can help give shape to your ideas and partner with you to achieve your corporate objectives. Contact us to realize opportunities in:

INFORMATION MANAGEMENT

Enterprise Content Management (ECM)
 Document Management
 Automated Workflow Solutions
 Business Process Automation
 Security and Compliance
 Mobility

IT SERVICES

Application Services
 Cloud Services
 IT Security
 Managed IT Services
 IT Consulting & Projects
 Business Consulting Services

TECHNOLOGY

Office Multifunction Business Solutions
 Commercial and Production Printers
 3D Printers
 Wide Format Printers
 Laptops, Desktops and Computer Hardware
 Servers and Networking Equipment
 Managed Print Services (MPS)
 Managed Enterprise Services



KONICA MINOLTA

KONICA MINOLTA BUSINESS SOLUTIONS U.S.A., INC.
 100 Williams Drive, Ramsey, New Jersey 07446

[CountOnKonicaMinolta.com](https://www.CountOnKonicaMinolta.com)



Item #: 4700iSS
 1/2021-Z